

**GENERAL NOTES**

- All work modeled on this plan shall be done in conformity with applicable provisions of Standard Specifications for Work and Standard Drawing for Detail on file in the Office of the City Engineer.
- Disturbance (Markings and Signs) shall be the responsibility of the contractor.
- To be removed and replaced with the same.
- To be removed and replaced with the same.
- To be removed and replaced with the same.
- To be removed and replaced with the same.
- To be removed and replaced with the same.
- To be removed and replaced with the same.
- To be removed and replaced with the same.
- To be removed and replaced with the same.

Specs for the same as Osborn Road and Highland Ave. (See Standard Drawing 8-221-C) EL. 1179.36 to 1185.22.

5 Apply from C.P. point to 5' along.

**PROFILE**  
Scale: Horiz. 1"=20'  
Vert. 1"=4'

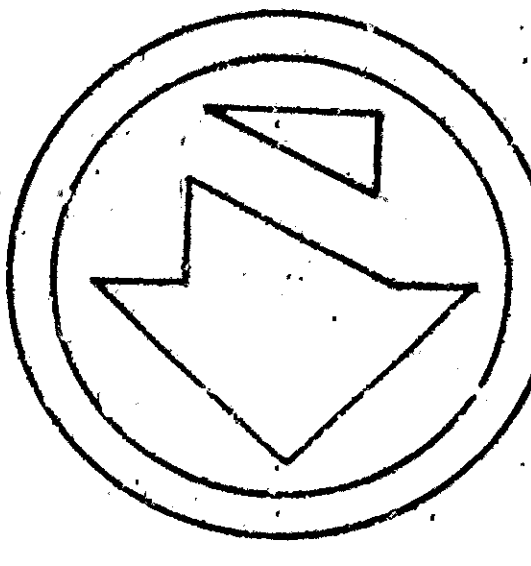


APPROVED	1944
REGISTERED CIVIL ENGINEER NO. 11621	
DRAWING NO. 3492	
CHECKED BY	
SHEET 1 OF 1	
RECOMMENDED	

DEPARTMENT OF ENGINEERING  
**CITY OF SAN BERNARDINO**  
OSBORN ROAD  
From Highland Avenue 5' a point 500' N. West  
Curb, Gutter and Sidewalk

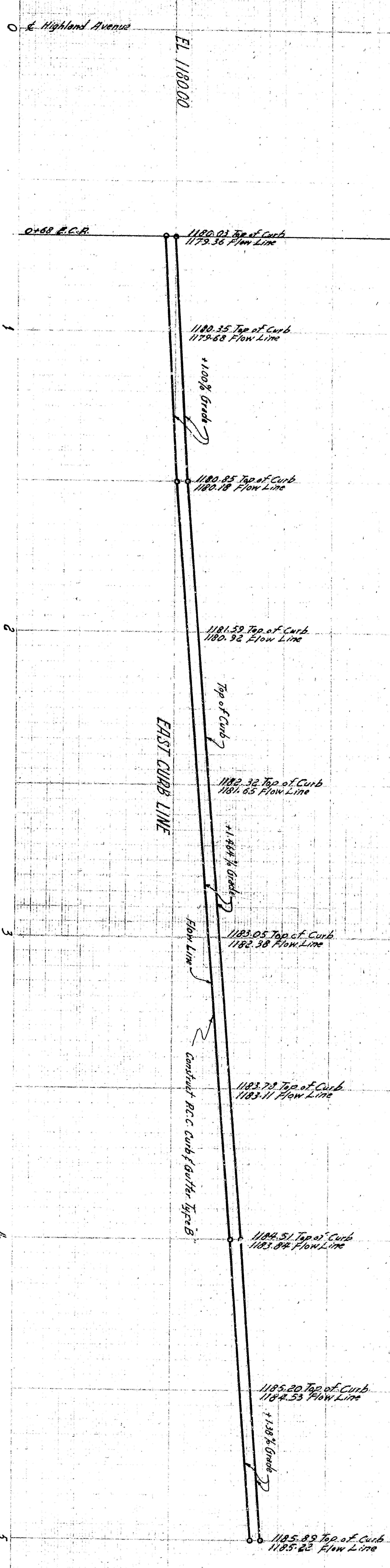

**GENERAL NOTES**

- All work shall be done in accordance with applicable provisions of Standard Specifications for Highway Construction, 1987 Edition, as amended, and the City Engineer's Office.
- Disturbance (Working on Pipe) shall be as follows:
  - To be removed and replaced with the same material.
  - To be removed and replaced with the same material.
  - To be removed and replaced with the same material.
- When Contract does not include a contract for the same, the Contractor shall provide and apply with and under the provisions of the City Engineer's Office. All measurements for paving and grading work shall be made on the ground surface. All measurements shall be made on the ground surface. All measurements shall be made on the ground surface.
- Apply from City Engineer's Office.

**PROFILE**  
Scale: Horiz. 1"=20'  
Vert. 1"=4'

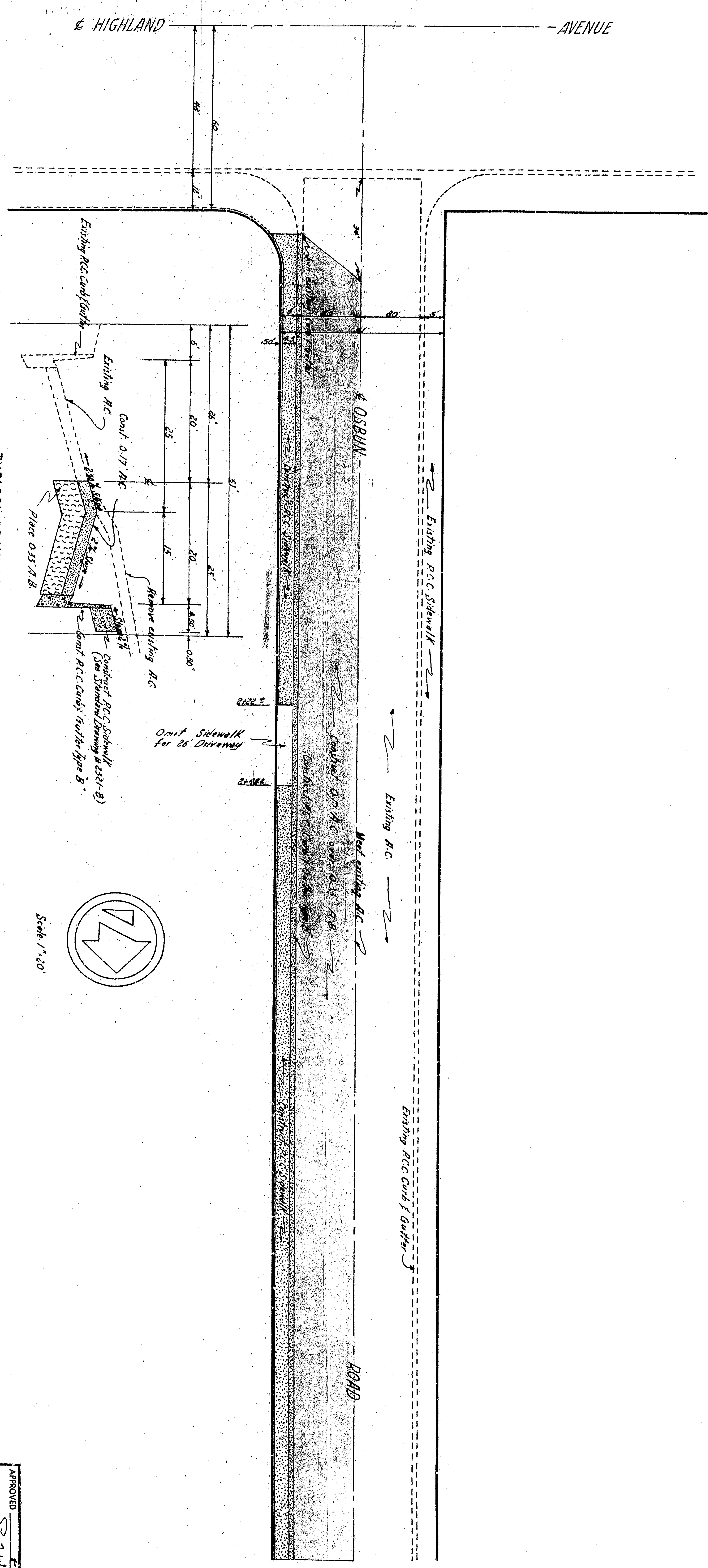

**TYPICAL SECTION**  
Scale: Horiz. 1"=20'  
Vert. 1"=4'

APPROVED	1988	DEPARTMENT OF ENGINEERING <b>CITY OF SAN BERNARDINO</b>  <b>OSBURN ROAD</b> From Highland Avenue to a point 500' West Curb/Gutter and Driveway
REGISTERED CIVIL ENGINEER NO. 11621		
DRAWING NO. 1		
SHEET 1 OF 1		